

# Bitterroot 100 Series

## 32 Gallon Bear Proof Receptacle

### Product Specifications, Information, & Installation Instructions

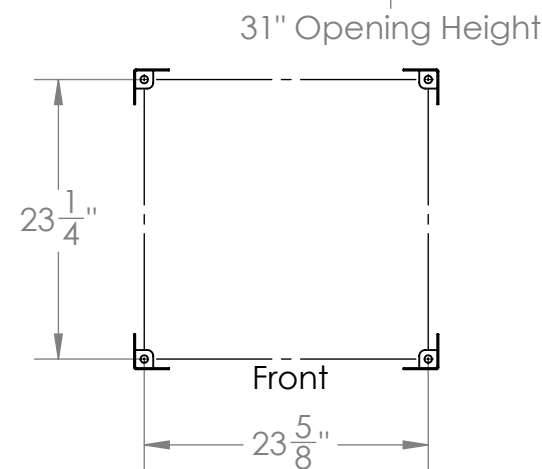
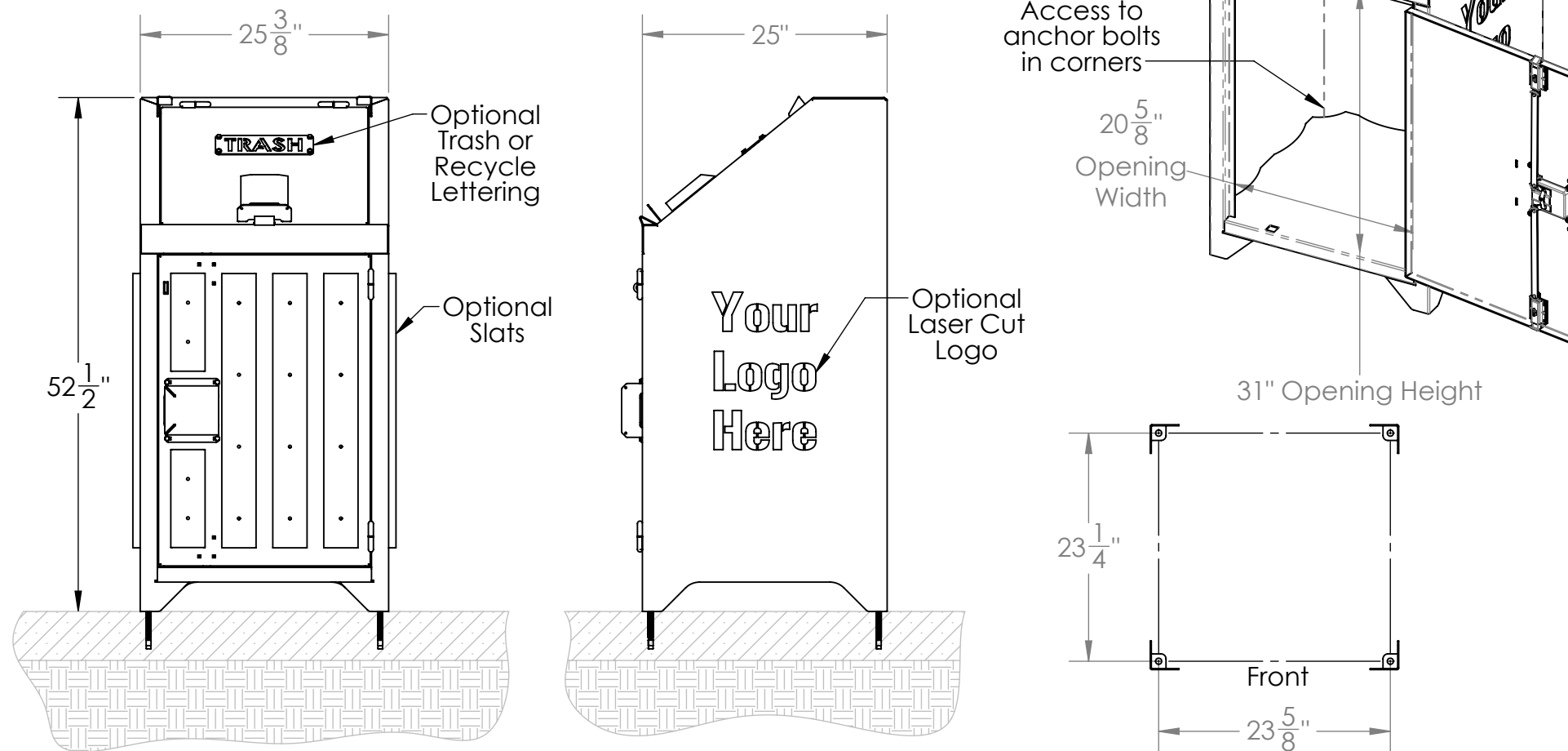

**Anchor Bolt Layout**



**BEAR  
GUARDIAN**

[www.bearguardian.com](http://www.bearguardian.com)



**MADE IN THE USA**

The Bitterroot 100 Series Receptacles are designed to enclose a 32 gallon round trash can (included). The access door is equipped with a bear resistant, ADA compliant paddle latch that locks into place when the door is released preventing the door from being left open. The unloading door for removing the trash is simple to use requiring little effort for trash removal.

The sturdy body and doors are constructed from durable 12 gauge (.105" thick) steel. The exterior of the container is sandblasted then coated with 2-3 mils of a Super Durable TGIC polyester coating in the customer's choice of color. This finish prevents chalking and color degradation over time.

Available options include: a custom laser-cut logo, an integral locking hasp, and weathered redwood toned plastic slats. The optional lettering available for the top door is: "TRASH" or "RECYCLE".

Standard Colors: Black (BL), Blue (B), Brown (BR), Forest Service Green (GR), Classic Grey (CG), Copper Vein (CV), Sierra Tan (ST), Medium Bronze (MB), and Statuary Bronze (SB).

The Bitterroot 100 Series Receptacles were successfully tested by the Living With Wildlife Foundation (LWWF) at The Grizzly and Wolf Discovery Center and are also Certified Bear Resistant by the Interagency Grizzly Bear Committee.

All Bear Guardian products are made in America from no less than 70% recycled steel and are backed by a one year manufacturer warranty.

#### Installation Instructions

Four each 3/8" x 4" long wedge anchors, 3/8" flat washers, and 3/8" hex nuts are required for mounting.

1. Lay out the location of the anchor bolts in the desired location according to the dimensions shown.
2. Using a 3/8" diameter carbide drill bit, drill the four holes to any depth exceeding the desired embedment. A minimum depth of 3" is recommended.
3. Clean drill fines from hole.
4. Assemble washer and nut, leaving nut flush with end of the anchor to protect threads. Drive each anchor into a hole. Once the recommended depth of 3" is achieved, hand tighten the nut until the washer is flush to surface of the concrete.
5. Expand the anchor by tightening the nut 3-5 turns past the hand tight position, or to the specified torque requirement.
6. Remove the nuts and washers from the anchors.
7. Place the receptacle over the anchors and reinstall the washers and nuts. There are access holes in each corner of the bottom of the receptacle to accommodate tightening the nuts.